

Sample Kit Contents

Part Number	Dimensions (mm)				Weight (g)	Case Color ¹	Quantity
	A Maximum	B Maximum	C Maximum	ϕ D			
ESD-SR-100	16.5	16.5	21.0	≤ 6.0	7.2	Black, Gray, Violet	3
ESD-SR-110	14.4	14.2	28.0	≤ 5.0	6.9	Black, Gray, Violet	3
ESD-SR-S10	15.5	14.0	18.5	≤ 6.0	4.1	Black	3
ESD-SR-120	16.0	16.4	33.0	≤ 6.0	13.3	Black, Gray, Violet	3
ESD-SR-150	19.6	20.3	37.4	≤ 7.0	23.4	Black, Gray, Violet	3
ESD-SR-160	20.2	20.0	39.0	≤ 9.0	22.7	Black, Gray, Violet	3
ESD-SR-250	31.5	31.6	38.0	≤ 13.0	59.5	Black, Gray, Violet	3
ESD-SR-S16	23.0	20.0	20.5	≤ 8.0	12.9	Black	3
ESD-SR-S25	33.0	29.0	15.5	≤ 14.5	21.3	Black	3

¹ Case color code added to end of ESD-SR part number: Blank = black, G = gray, V = violet. ESD-SR-S series only available in black.

Dimensions – Millimeters

ESD-SR

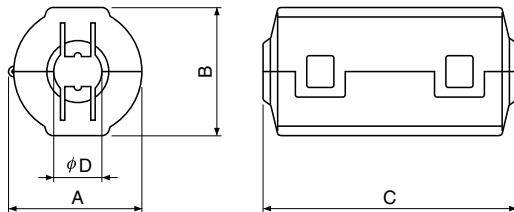

ESD-SR-S

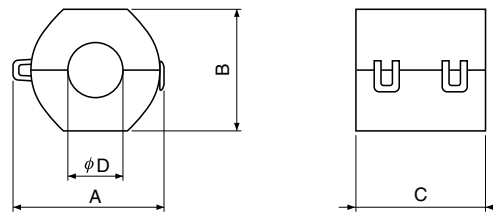

See table above for dimensions

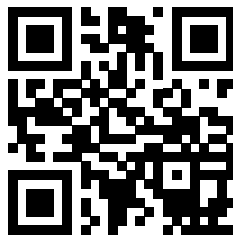

www.kemet.com/ESD-SR